

PROJECT NOTES

- I. SITE INFORMATION OBTAINED FROM THE FOLLOWING:
 - A. COLLIERS ENGINEERING & DESIGN DID NOT VISIT THIS SITE TO VERIFY EXISTING CONDITIONS. ANY CONFLICT WITH THE PROPOSED DESIGN MUST BE DISCUSSED WITH THE CONSTRUCTION MANAGER.
 - B. A SURVEY HAS NOT BEEN CONDUCTED BY COLLIERS ENGINEERING AND DESIGN. THIS PLAN WAS PREPARED WITHOUT THE BENEFIT OF A TITLE REPORT AND IS SUBJECT TO ALL EASEMENTS AND RESTRICTIONS OF RECORD.
2. THE CONTRACTOR SHALL COMPLY WITH ALL APPLICABLE CODES, ORDINANCES, LAWS AND REGULATIONS OF ALL MUNICIPALITIES, UTILITY COMPANIES OR OTHER PUBLIC/GOVERNING AUTHORITIES.
3. THE CONTRACTOR SHALL BE RESPONSIBLE FOR OBTAINING ALL PERMITS AND INSPECTIONS THAT MAY BE REQUIRED BY ANY FEDERAL, STATE, COUNTY OR MUNICIPAL AUTHORITIES.
4. THE CONTRACTOR SHALL NOTIFY THE CONSTRUCTION MANAGER, IN WRITING, OF ANY CONFLICTS, ERRORS OR OMISSIONS PRIOR TO THE SUBMISSION OF BIDS OR PERFORMANCE OF WORK.
5. THE CONTRACTOR SHALL BE RESPONSIBLE FOR PROTECTING ALL EXISTING SITE IMPROVEMENTS PRIOR TO COMMENCING CONSTRUCTION. THE CONTRACTOR SHALL REPAIR ANY DAMAGE AS A RESULT OF CONSTRUCTION OF THIS FACILITY AT THE CONTRACTOR'S EXPENSE TO THE SATISFACTION OF THE OWNER.
6. THE SCOPE OF WORK FOR THIS PROJECT SHALL INCLUDE PROVIDING ALL MATERIALS, EQUIPMENT AND LABOR REQUIRED TO COMPLETE THIS PROJECT. ALL EQUIPMENT SHALL BE INSTALLED IN ACCORDANCE WITH MANUFACTURER'S RECOMMENDATIONS.
7. THE CONTRACTOR SHALL VISIT THE PROJECT SITE PRIOR TO SUBMITTING THE BID TO VERIFY THAT THE PROJECT CAN BE CONSTRUCTED IN ACCORDANCE WITH THE CONTRACT DOCUMENTS AND CONSTRUCTION DRAWINGS.
8. THE CONTRACTOR SHALL VERIFY ALL EXISTING DIMENSIONS AND CONDITIONS PRIOR TO COMMENCING ANY WORK. ALL DIMENSIONS OF EXISTING CONSTRUCTION SHOWN ON THESE DRAWINGS MUST BE VERIFIED. THE CONTRACTOR SHALL NOTIFY THE CONSTRUCTION MANAGER OF ANY DISCREPANCIES PRIOR TO ORDERING MATERIAL OR PROCEEDING WITH CONSTRUCTION.
9. THE PROPOSED FACILITY WILL COMPLY WITH ALL STATE AND LOCAL STORMWATER ORDINANCES.
10. NO NOISE, SMOKE, DUST OR ODOR WILL RESULT FROM THIS FACILITY AS TO CAUSE A NUISANCE.
11. THE FACILITY DOES NOT REQUIRE POTABLE WATER OR SANITARY SERVICE.
12. CONTRACTOR MUST FIELD LOCATE ALL EXISTING UNDERGROUND UTILITIES PRIOR TO ANY EXCAVATION.
13. CONTRACTOR SHALL CONTACT STATE SPECIFIC ONE CALL SYSTEM THREE WORKING DAYS PRIOR TO ANY EARTH MOVING ACTIVITIES.

**COPYRIGHT © 2025
COLLIERS ENGINEERING & DESIGN
ALL RIGHTS RESERVED**

THIS DRAWING AND ALL THE INFORMATION CONTAINED HEREIN IS
AUTHORIZED FOR USE ONLY BY THE PARTY FOR WHOM THE WORK
WAS CONTRACTED OR TO WHOM IT IS CERTIFIED. THIS DRAWING MAY
NOT BE COPIED, REUSED, DISCLOSED, DISTRIBUTED OR RELIED UPON
FOR ANY OTHER PURPOSE WITHOUT THE EXPRESS WRITTEN CONSENT
OF COLLIERS ENGINEERING & DESIGN.

UNAUTHORIZED ALTERATION OR ADDITION TO A SURVEY OR ENGINEERING MAP BEARING A LICENSED LAND SURVEYOR OR PROFESSIONAL ENGINEER IS A VIOLATION OF SECTION 7209, SUB-DIVISION 2, OF THE NEW YORK STATE EDUCATION LAW. ONLY MAPS WITH THE LAND SURVEYOR OR PROFESSIONAL ENGINEER'S SEAL ARE GENUINE TRUE AND CORRECT COPIES OF THE LAND SURVEYOR OR PROFESSIONAL ENGINEER'S ORIGINAL WORK AND OPINION.



SITE NAME:
FAIRFIELD INN AND SUITES

915 HARD ROAD
WEBSTER, NY 14580
MONROE COUNTY

VICINITY MAP

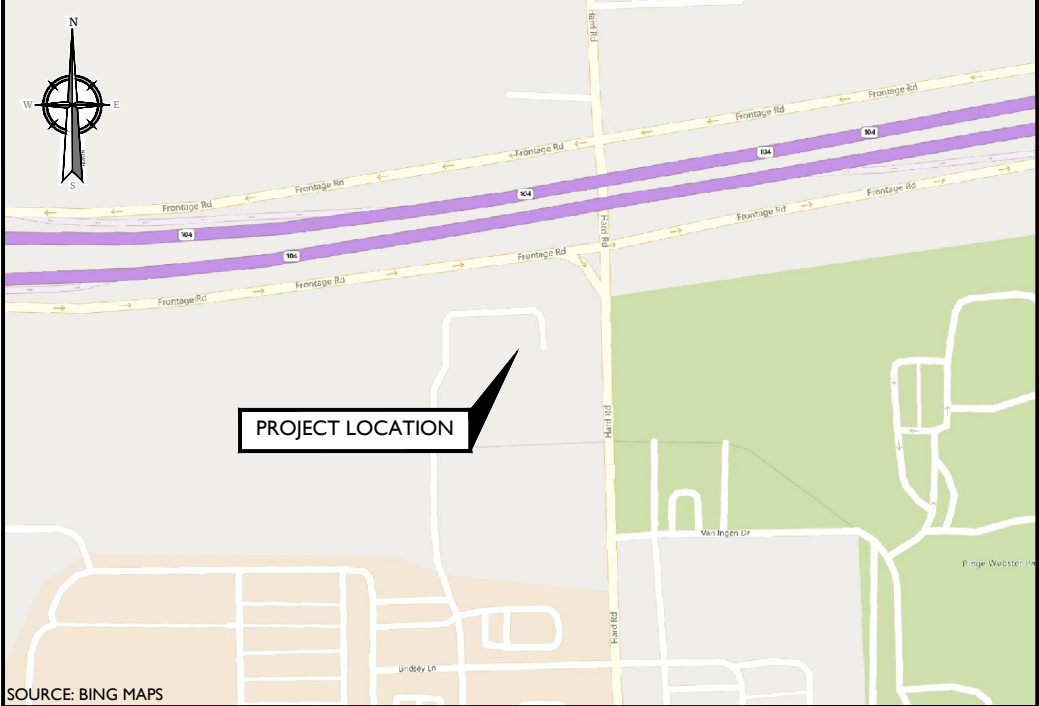

CODE COMPLIANCE

ALL WORK AND MATERIALS SHALL BE PERFORMED AND INSTALLED IN ACCORDANCE WITH THE CURRENT EDITIONS OF THE FOLLOWING CODES AS ADOPTED BY THE LOCAL GOVERNING AUTHORITIES. NOTHING IN THESE PLANS IS TO BE CONSTRUED TO PERMIT WORK NOT CONFORMING TO THE LATEST EDITIONS OF THE FOLLOWING CODES.

- | | |
|--|---|
| 1. 2020 BUILDING CODE OF NYS, INCORPORATING THE 2018 IBC | 8. INSTITUTE FOR ELECTRICAL AND ELECTRONICS ENGINEERS 81 IEEE C2 LATEST EDITION |
| 2. 2017 NEC | 9. TELCORDIA GR-1275 |
| 3. 2020 NYS FIRE CODE | 10. ANSI T1.31 I |
| 4. AMERICAN INSTITUTE OF STEEL CONSTRUCTION 360-16 | 11. PROPOSED USE: ELECTRIC VEHICLE CHARGING |
| 5. AMERICAN CONCRETE INSTITUTE | 12. SECTION 625 OF THE NATIONAL ELECTRICAL CODE (NFPA 70) |
| 6. CONSTRUCTION TYPE: IIB | |
| 7. USE GROUP: S2 | |

PROJECT INFORMATION

SITE INFORMATION

LATITUDE: 43.213131° (GOOGLE EARTH)
 LONGITUDE: -77.461931° (GOOGLE EARTH)
 GROUND ELEVATION: 407'± AMSL (GOOGLE EARTH)
 JURISDICTION: TOWN OF WEBSTER
 COUNTY: MONROE COUNTY

APPLICANT

COMPANY: CHARGESMART EV
ADDRESS: 5 SOUTHSIDE DRIVE, SUITE 11-184
CITY, STATE, ZIP: CLIFTON PARK, NY 12065

PROPERTY OWNER

OWNER: WIDEWATERS 5 MILELINE ASOC LLC
ADDRESS: 1 FOUNTAIN PLZ
CITY, STATE, ZIP: BUFFALO, NY 14203-1495

ENGINEERING COMPANY

COMPANY: COLLIERS ENGINEERING & DESIGN, INC
ADDRESS: 2000 MIDLANTIC DRIVE, SUITE 100
CITY, STATE, ZIP: MT. LAUREL, NJ 08054
CONTACT: STEPHANIE MULHERN
OWNS: (856) 797-0412
E-MAIL: STEPHANIE.MULHERN@COLLIERSENG.COM

SCOPE OF WORK

- SUPPLY AND INSTALL (1) PANEL BOARD
- SUPPLY AND INSTALL (1) METER/DISCONNECT
- SUPPLY AND INSTALL (2) 48A DUAL PORT ELECTRIC VEHICLE CHARGERS
- SUPPLY AND INSTALL (3) CONCRETE PADS
- SUPPLY AND INSTALL REQUIRED CONDUIT/WIRING
- PROVIDE TRENCHING/RESTORATION AS REQUIRED

SHEET INDEX	
1	COVER SHEET
2	GENERAL NOTES
3	PROPOSED IMPROVEMENTS
4	PROPOSED IMPROVEMENTS
5	PROPOSED IMPROVEMENTS
6	PROPOSED IMPROVEMENTS
7	PROPOSED IMPROVEMENTS
8	PROPOSED IMPROVEMENTS
9	PROPOSED IMPROVEMENTS
10	PROPOSED IMPROVEMENTS
11	PROPOSED IMPROVEMENTS
12	PROPOSED IMPROVEMENTS
13	PROPOSED IMPROVEMENTS
14	PROPOSED IMPROVEMENTS
15	PROPOSED IMPROVEMENTS
16	PROPOSED IMPROVEMENTS
17	PROPOSED IMPROVEMENTS
18	PROPOSED IMPROVEMENTS
19	PROPOSED IMPROVEMENTS
20	PROPOSED IMPROVEMENTS
21	PROPOSED IMPROVEMENTS
22	PROPOSED IMPROVEMENTS
23	PROPOSED IMPROVEMENTS
24	PROPOSED IMPROVEMENTS
25	PROPOSED IMPROVEMENTS
26	PROPOSED IMPROVEMENTS
27	PROPOSED IMPROVEMENTS
28	PROPOSED IMPROVEMENTS
29	PROPOSED IMPROVEMENTS
30	PROPOSED IMPROVEMENTS
31	PROPOSED IMPROVEMENTS
32	PROPOSED IMPROVEMENTS
33	PROPOSED IMPROVEMENTS
34	PROPOSED IMPROVEMENTS
35	PROPOSED IMPROVEMENTS
36	PROPOSED IMPROVEMENTS
37	PROPOSED IMPROVEMENTS
38	PROPOSED IMPROVEMENTS
39	PROPOSED IMPROVEMENTS
40	PROPOSED IMPROVEMENTS
41	PROPOSED IMPROVEMENTS
42	PROPOSED IMPROVEMENTS
43	PROPOSED IMPROVEMENTS
44	PROPOSED IMPROVEMENTS
45	PROPOSED IMPROVEMENTS
46	PROPOSED IMPROVEMENTS
47	PROPOSED IMPROVEMENTS
48	PROPOSED IMPROVEMENTS
49	PROPOSED IMPROVEMENTS
50	PROPOSED IMPROVEMENTS
51	PROPOSED IMPROVEMENTS
52	PROPOSED IMPROVEMENTS
53	PROPOSED IMPROVEMENTS
54	PROPOSED IMPROVEMENTS
55	PROPOSED IMPROVEMENTS
56	PROPOSED IMPROVEMENTS
57	PROPOSED IMPROVEMENTS
58	PROPOSED IMPROVEMENTS
59	PROPOSED IMPROVEMENTS
60	PROPOSED IMPROVEMENTS
61	PROPOSED IMPROVEMENTS
62	PROPOSED IMPROVEMENTS
63	PROPOSED IMPROVEMENTS
64	PROPOSED IMPROVEMENTS
65	PROPOSED IMPROVEMENTS
66	PROPOSED IMPROVEMENTS
67	PROPOSED IMPROVEMENTS
68	PROPOSED IMPROVEMENTS
69	PROPOSED IMPROVEMENTS
70	PROPOSED IMPROVEMENTS
71	PROPOSED IMPROVEMENTS
72	PROPOSED IMPROVEMENTS
73	PROPOSED IMPROVEMENTS
74	PROPOSED IMPROVEMENTS
75	PROPOSED IMPROVEMENTS
76	PROPOSED IMPROVEMENTS
77	PROPOSED IMPROVEMENTS
78	PROPOSED IMPROVEMENTS
79	PROPOSED IMPROVEMENTS
80	PROPOSED IMPROVEMENTS
81	PROPOSED IMPROVEMENTS
82	PROPOSED IMPROVEMENTS
83	PROPOSED IMPROVEMENTS
84	PROPOSED IMPROVEMENTS
85	PROPOSED IMPROVEMENTS
86	PROPOSED IMPROVEMENTS
87	PROPOSED IMPROVEMENTS
88	PROPOSED IMPROVEMENTS
89	PROPOSED IMPROVEMENTS
90	PROPOSED IMPROVEMENTS
91	PROPOSED IMPROVEMENTS
92	PROPOSED IMPROVEMENTS
93	PROPOSED IMPROVEMENTS
94	PROPOSED IMPROVEMENTS
95	PROPOSED IMPROVEMENTS
96	PROPOSED IMPROVEMENTS
97	PROPOSED IMPROVEMENTS
98	PROPOSED IMPROVEMENTS
99	PROPOSED IMPROVEMENTS
100	PROPOSED IMPROVEMENTS

[illegible]

www.colliersengineering.com

Copyright © 2025, Colliers Engineering & Design All Rights Reserved. This drawing and all the information contained herein is authorized for use only by the party for whom the services were contracted or to whom it is certified. This drawing may not be copied, reused, disclosed, distributed or relied upon for any other purpose without the express written consent of Colliers Engineering & Design.



FOR STATE SPECIFIC DIRECT PHONE NUMBERS VISIT:
WWW.CALL811.COM

SCALE:						JOB NUMBER:							
AS SHOWN						25902012							
-	-	-	-	-	-	-	-	-	-	-	-	-	-
-	-	-	-	-	-	-	-	-	-	-	-	-	-
-	-	-	-	-	-	-	-	-	-	-	-	-	-
-	-	-	-	-	-	-	-	-	-	-	-	-	-
-	-	-	-	-	-	-	-	-	-	-	-	-	-
-	-	-	-	-	-	-	-	-	-	-	-	-	-
-	-	-	-	-	-	-	-	-	-	-	-	-	-
-	-	-	-	-	-	-	-	-	-	-	-	-	-
A	04/21/25	ISSUED FOR REVIEW							JJK	SLM			
REV	DATE	DESCRIPTION							DRAWN BY	CHECKED BY			

Stephanie Mulhern
NEW YORK LICENSED PROFESSIONAL ENGINEER
LICENSE NUMBER: 110126
COLLIERS ENGINEERING & DESIGN CT, P.C.
N.Y. C.O.A #: 0017609

IT IS A VIOLATION OF LAW FOR ANY PERSON,
UNLESS THEY ARE ACTING UNDER THE DIRECTION
OF THE RESPONSIBLE LICENSED PROFESSIONAL
ENGINEER, TO ALTER THIS DOCUMENT.

SITE NAME:

FAIRFIELD INN AND SUITES

915 HARD ROAD
WEBSTER, NY 14580
MONROE COUNTY



Engineering
& Design

MT. LAUREL
2000 Midlantic Drive,
Suite 100
Mt. Laurel, NJ 08054
Phone: 856.797.0412
COLLIERS ENGINEERING & DESIGN,
ARCHITECTURE, LANDSCAPE ARCHITECT

SHEET TITLE :

TITLE SHEET

SHEET NUMBER : _____

T-1

NOTE: DO NOT SCALE DRAWINGS FOR CONSTRUCTION

DESIGN CRITERIA

I. NOTABLE CODE ITEMS:

- 1.1.1. WHERE PROVIDED, ELECTRIC VEHICLE CHARGING STATIONS SHALL BE INSTALLED IN ACCORDANCE WITH NFPA 70. ELECTRIC VEHICLE CHARGING SYSTEM EQUIPMENT SHALL BE LISTED AND LABELED IN ACCORDANCE WITH UL 2202. ELECTRIC VEHICLE SUPPLY EQUIPMENT SHALL BE LISTED AND LABELED IN ACCORDANCE WITH UL 2594.

2. NFPA-70 NATIONAL ELECTRIC CODE:

- 2.1. ALL WORK WITHIN THESE DRAWINGS SHALL ADHERE TO NEC 625 ELECTRIC VEHICLE CHARGING SYSTEM.

625.1 SCOPE

- THIS ARTICLE COVERS THE ELECTRICAL CONDUCTORS AND EQUIPMENT EXTERNAL TO AN ELECTRIC VEHICLE THAT CONNECTS AN ELECTRIC VEHICLE TO A SUPPLY OF ELECTRICITY BY CONDUCTIVE, INDUCTIVE, OR WIRELESS POWER TRANSFER (CONTACTLESS INDUCTIVE CHARGING) MEANS, AND THE INSTALLATION OF EQUIPMENT AND DEVICES RELATED TO ELECTRIC VEHICLE CHARGING.
- INFORMATIONAL NOTE NUMBER 1: FOR INDUSTRIAL TRUCKS, SEE NFPA 505-2013, FIRE SAFETY STANDARD FOR POWERED INDUSTRIAL TRUCKS INCLUDING TYPE OF DESIGNATIONS, AREAS OF USE, CONVERSIONS, MAINTENANCE AND OPERATION.
 - INFORMATIONAL NOTE NUMBER 2: UL 2594-2013, STANDARD FOR ELECTRIC VEHICLE SUPPLY EQUIPMENT, IS A SAFETY STANDARD FOR CONDUCTIVE ELECTRIC VEHICLE SUPPLY EQUIPMENT. UL 2202-2009, STANDARD FOR ELECTRIC VEHICLE CHARGING SYSTEM EQUIPMENT, IS A SAFETY STANDARD FOR CONDUCTIVE ELECTRIC VEHICLE CHARGING EQUIPMENT.

GENERAL ELECTRICAL NOTES

1. ELECTRICAL CONTRACTOR SHALL PROVIDE TYPE-WRITTEN SCHEDULES OF ALL CIRCUITRY IN ALL PANELS. SCHEDULES SHALL MATCH THE LOADS SHOW IN THE PROJECT PANEL SCHEDULE INCLUDED IN THESE DRAWINGS. ALL SPARE PANEL SPACES SHALL BE FULLY PROTECTED WITH METAL BLANKS.
2. ELECTRICAL DEVICES, MATERIALS AND PACKAGED EQUIPMENT SHALL BE LISTED AND LABELED BY A NATIONALLY RECOGNIZED TESTING LABORATORY (NRTL) SUCH AS UNDERWRITERS LABORATORIES INC. (UL). FOR THE INTENDED USE, AND SHALL BEAR ITS LABEL. NOTE THAT THE NRTL APPROVAL OF INDIVIDUAL COMPONENTS OF PACKAGED EQUIPMENT DOES NOT CONSTITUTE APPROVAL OF THE ENTIRE PACKAGE.
3. ALL ELECTRICAL WORK SHALL BE PERFORMED IN ACCORDANCE WITH THE NATIONAL ELECTRIC CODE (NECA) AND THE BUILDING CODE REFERENCED ON SHEET T-1.
4. OWNER IS TO PAY FOR ALL REQUIRED FEES AND THE CONTRACTOR SHALL OBTAIN ANY NECESSARY PERMITS. THE ELECTRICAL CONTRACTOR SHALL ARRANGE FOR ALL INSPECTIONS AND SUBMIT COPIES OF ACCEPTANCE CERTIFICATES TO OWNER PRIOR TO THE COMPLETION OF THE PROJECT.
5. ELECTRICAL CONTRACTOR SHALL PROVIDE AND INSTALL ALL BOXES, FITTINGS, CONNECTORS, COVER PLATES AND OTHER MISCELLANEOUS ITEMS, NOT NECESSARILY DETAIL ON THESE DRAWINGS, TO RENDER THE ELECTRICAL INSTALLATION COMPLETE AND OPERATIVE, AND IN COMPLIANCE WITH APPLICABLE CODES.
6. ALL WIRING SHALL BE COPPER CONDUCTOR, MINIMUM SIZE #12 AWG, UNLESS OTHERWISE NOTED.
7. ELECTRICAL CONTRACTOR SHALL FIELD VERIFY LOCATION OF EXISTING EQUIPMENT AND NOTE CONDITIONS AND AREAS WHERE WORK WILL OCCUR IN THE FIELD.
8. ELECTRICAL CONTRACTOR SHALL COORDINATE WITH AND MEET ALL REQUIREMENTS OF SERVING UTILITY COMPANY.
9. ELECTRICAL CONTRACTOR SHALL COORDINATE WITH ALL OTHER TRADES TO AVOID CONFLICTS OF EQUIPMENT INSTALLATION. ELECTRICAL CONTRACTOR SHALL VERIFY EXACT LOCATIONS OF ALL EQUIPMENT LOCATIONS, WIRING DEVICES AND LIGHTING WITH ENGINEER PRIOR TO INSTALLATION.
10. ELECTRICAL CONTRACTOR SHALL SUBMIT EQUIPMENT SHOP DRAWINGS FOR APPROVAL BY ENGINEER PRIOR TO COMMENCING INSTALLATION.
11. ELECTRICAL CONTRACTOR SHALL BE RESPONSIBLE FOR ALL CUTTING, PATCHING, AND PAINTING ASSOCIATED WITH ELECTRICAL WORK.
12. ELECTRICAL CONTRACTOR SHALL GUARANTEE ALL WORKMANSHIP AND MATERIAL INSTALLED UNDER THIS CONTRACT TO BE FREE FROM DEFECTS FOR A PERIOD OF ONE (1) YEAR FROM DATE OF COMPLETION AND ACCEPTANCE BY THE OWNER. CONTRACTOR AGREES TO REPLACE ANY DEFECTIVE EQUIPMENT AT NO ADDITIONAL COST TO THE OWNER FOR THE DURATION OF THE GUARANTEE PERIOD.
13. CONTRACTOR IS RESPONSIBLE FOR ALL TRENCHING, EXCAVATION AND BACKFILL ASSOCIATED WITH THE ELECTRICAL WORK. PRIOR TO PERFORMING ANY EXCAVATIONS, THE CONTRACTOR SHALL CONTACT THE STATE SPECIFIC ONE CALL SYSTEM THREE WORKING DAYS PRIOR TO ANY EARTH MOVING ACTIVITIES.
14. CONTRACTOR SHALL PROTECT EXISTING ASPHALT PARKING LOTS, DRIVEWAYS AND CONCRETE CURBING THROUGHOUT THE PROJECT DURATION. CONTRACTOR TO REPAIR PARKING LOTS, DRIVEWAY AND CURBING DAMAGED AS A RESULT OF ELECTRICAL WORK. REPAIRS SHALL MATCH EXISTING CONDITIONS OF BETTER.
15. SITE RESTORATION - WHERE AND AS INDICATED BY THE OWNER'S REPRESENTATIVE, THE CONTRACTOR SHALL REPLACE ALL SURFACED DISTURBED AND SHALL RESTORE PAVING, CURBING, SIDEWALKS, DRIVEWAYS, SHRUBBERY, GRASS AREAS AND ALL OTHER SURFACES DISTURBED TO A CONDITION EQUAL TO OR BETTER THAN THAT WHICH EXISTED BEFORE THE WORK BEGAN, FURNISHING ALL LABOR, MATERIAL AND EQUIPMENT NECESSARY THERETO. THE CONTRACTOR SHALL, AT SAID CONTRACTOR'S OWN EXPENSE AND THE TO THE SATISFACTION OF THE OWNER'S REPRESENTATIVE, CLEAN UP AND CORRECT UNSIGHTLINESS, INCONVENIENCE, HAZARD OR DAMAGE CAUSED BY WATER, MUD, STONES, DUST, RUBBISH, CONSTRUCTION DEBRIS, TRAFFIC, WORKMEAN OR THE GENERAL OPERATIONS. WHEEL TRACKS, PATHS, PUDDLES, DAMAGED GROWTH, RAGGED EDGES, UNDESIRABLE SPOIL FROM EXCAVATION AND ROUGH SLOPES ARE TO BE REMOVED, OBLITERATED, CORRECTED, GRADED, LEVELED PATCHED OR SMOOTHED. ALL ADJACENT AREAS THAT HAVE BEEN DAMAGED OR THAT REQUIRE REGRADING SHALL BE SMOOTHED AND WORKED TO MAKE THE PROJECT AREA BLEND INTO EXISTING CONDITIONS. PROVIDE TOPSOIL, SEED AND MULCH WHERE REQUIRED FOR GRASS ESTABLISHMENT.

WIRING METHODS

1. ALL WIRING METHODS AND INSTALLATION PRACTICES SHALL CONFORM TO THE NATIONAL ELECTRIC CODE, LOCAL STATE CODES AND OTHER APPLICABLE LOCAL CODES.
2. SYSTEM CONDUCTORS SHALL BE RATED FOR 90° C, WET RATED, UV RESISTANT AND A MINIMUM OF 600V RATED.
3. SYSTEM CIRCUIT CONDUCTORS SHALL BE IDENTIFIED AT ALL TERMINATIONS, CONNECTIONS AND SPLICE POINTS AS REQUIRED PER NEC ARTICLE 690.31 (B) (1).
4. DC ELECTRICAL SYSTEM CONDUCTOR COLOR CONVENTIONS SHALL BE MARKED AS FOLLOWS:

DC CONDUCTOR MARKING CONVENTIONS			
	UNGROUND	SOLID GROUND	FUNCTIONAL GROUND
POSITIVE	RED	REF NEC ARTICLE 200 FOR GROUND CONDUCTOR JACKETING REQUIREMENTS	RED
NEGATIVE	BLACK		BLACK
GROUND	GREEN OR BARE	GREEN OR BARE	GREEN OR BARE

5. LOW VOLTAGE AC CONDUCTORS ($\leq 600V$) MUST BE 600V AND 90° C RATED
6. THREE PHASE AC ELECTRICAL SYSTEM CONDUCTOR COLOR CONVENTIONS SHALL BE MARKED AS FOLLOWS:

AC CONDUCTOR MARKING CONVENTIONS			
	120/208V	277/480V & 347/600V	1000V <
PHASE A	BLACK	BROWN	BLACK
PHASE B	RED	ORANGE	RED
PHASE C	BLUE	YELLOW	BLUE
NEUTRAL	WHITE	GRAY	-
GROUND	GREEN	GREEN	GREEN OR BARE

7. ALL WIRES INSTALLED IN FREE AIR TO BE SECURED VIA MECHANICAL MEANS. CONDUCTORS TO BE SECURED IN A MANNER THAT ENSURES PROTECTION AGAINST ABRASION, SHARP EDGES AND POTENTIAL INSULATION DAMAGING ELEMENTS.
8. CONDUCTORS ROUTED OUT OF A CONDUIT SHALL BE SUPPORTED AND SECURED AT INTERVALS DEFINED BY THE NEC.
9. CONDUCTORS ROUTED IN VERTICAL RACEWAYS SHALL BE SUPPORTED AS REQUIRED IN NEC 300.19.

GROUNDING NOTES

1. ALL ENCLOSURES AND NON-CURRENT CARRYING METALLIC PARTS OF THE ELECTRICAL SYSTEM, RACEWAY SYSTEMS AND EQUIPMENT GROUND BUSES SHALL BE GROUNDED TO THE GROUNDING SYSTEM VIA EQUIPMENT GROUNDING CONDUCTORS (EGC). GROUND CONTINUITY SHALL BE MAINTAINED THROUGHOUT.
2. EQUIPMENT GROUNDING CONDUCTORS SHALL BE SIZED PER NEC 250.122.
3. GROUNDING RODS SHALL BE 10'-0" LONG 3/4"Ø COPPER CLAD UNLESS OTHERWISE SPECIFIED.
4. GROUND RODS, GROUNDING ELECTRODE CONDUCTORS AND CONNECTIONS TO BE MADE A MINIMUM OR 30" BELOW GRADE UNLESS OTHERWISE SPECIFIED.

CONDUIT, CABLE TRAY AND RACEWAY NOTES

1. CONDUIT AND CABLE ROUTES ARE DIAGRAMMATIC AND REQUIRE CONTRACTOR FIELD VERIFICATION. SIGNIFICANT DEVIATION FROM THE PROPOSED ROUTE MUST BE COORDINATED PRIOR TO INSTALLATION.
2. WHERE CIRCUIT ROUTING IS NOT SHOWN AND THE DESTINATION IS INDICATED, THE CONTRACTOR SHALL DETERMINE AND COORDINATE THE EXACT ROUTE PRIOR TO INSTALLATION.
3. ALL OUTDOOR CONDUIT SHALL HAVE RAIN-TIGHT CONNECTORS AND COUPLINGS.
4. IN ADDITION TO THOSE SHOWN IN THE DRAWINGS, CONTRACTOR SHALL DETERMINE AND PROVIDE ENCLOSURES AS NECESSARY TO FACILITATE THE INSTALLATION OF WIRING. BENDS IN CONDUIT BETWEEN PULL BOXES SHALL NOT EXISTING 360° OF BEND.
5. PULL AND JUNCTION BOXES SHALL BE SIZED IN COMPLIANCE WITH NEC ARTICLE 314.
6. CONDUIT TO BE ROUTED IN A MANNER THAT DOES NOT OBSTRUCT EQUIPMENT WORKING CLEARANCES AND ACCESSIBILITY.
7. ALL OUTDOOR RATED ENCLOSURES SHALL BE NEMA 3R.
8. WHEN TRANSITIONING FROM FREE AIR TO CONDUIT, A LISTED FITTED SHALL BE USED TO PREVENT THE ENTRY OF MOISTURE.



Colliers Engineering & Design

www.colliersengineering.com

Copyright © 2025, Colliers Engineering & Design All Rights Reserved. This drawing and all the information contained herein is authorized for use only by the party for whom the services were contracted or to whom it is certified. This drawing may not be copied, reused, disclosed, distributed or relied upon for any other purpose without the express written consent of Colliers Engineering & Design.



ChargeSmart EV



PROTECT YOURSELF
ALL STATES REQUIRE NOTIFICATION OF
EXCAVATORS, DESIGNERS, OR ANY PERSONS
PREPARING TO DISTURB THE EARTH'S
SURFACE ANYWHERE IN ANY STATE

FOR STATE SPECIFIC DIRECT PHONE NUMBERS VISIT
WWW.CALL811.COM

SCALE: AS SHOWN

JOB NUMBER: 25902012

	-	-	-	-	-
-	-	-	-	-	-
-	-	-	-	-	-
-	-	-	-	-	-
-	-	-	-	-	-
-	-	-	-	-	-
-	-	-	-	-	-
-	-	-	-	-	-
A	04/21/25	ISSUED FOR REVIEW	JJK	SLM	
REV	DATE	DESCRIPTION	DRAWN BY	CHECKED BY	

Stephanie Mulhern

NEW YORK LICENSED PROFESSIONAL ENGINEER
 LICENSE NUMBER: 110126
 COLLIERS ENGINEERING & DESIGN CT, P.C.
 N.Y. C.O.A #: 0017609

IT IS A VIOLATION OF LAW FOR ANY PERSON,
UNLESS THEY ARE ACTING UNDER THE DIRECTION
OF THE RESPONSIBLE LICENSED PROFESSIONAL
ENGINEER, TO ALTER THIS DOCUMENT.

SITE NAME:

FAIRFIELD INN AND SUITES

915 HARD ROAD
WEBSTER, NY 14580
MONROE COUNTY



Engineering
& Design

MT. LAUREL
2000 Midlantic Drive,
Suite 100
Mt. Laurel, NJ 08054
Phone: 856.797.0412
COLLIERS ENGINEERING & DESIGN,
ARCHITECTURE, LANDSCAPE ARCHITECTURE
SURVEYING CT, P.C.

SHEET TITLE

PROJECT NOTES

SHEET NUMBER

GN-

UNAUTHORIZED ALTERATION OR ADDITION TO A SURVEY OR ENGINEERING MAP BEARING A LICENSED LAND SURVEYOR OR PROFESSIONAL ENGINEER IS A VIOLATION OF SECTION 7209, SUB-DIVISION 2, OF THE NEW YORK STATE EDUCATION LAW. ONLY MAPS WITH THE LAND SURVEYOR OR PROFESSIONAL ENGINEER'S SEAL ARE GENUINE TRUE AND CORRECT COPIES OF THE LAND SURVEYOR OR PROFESSIONAL ENGINEER'S ORIGINAL WORK AND OPINION.

NOTE: DO NOT SCALE DRAWINGS FOR CONSTRUCTION



NOTE: DO NOT SCALE DRAWINGS FOR CONSTRUCTION

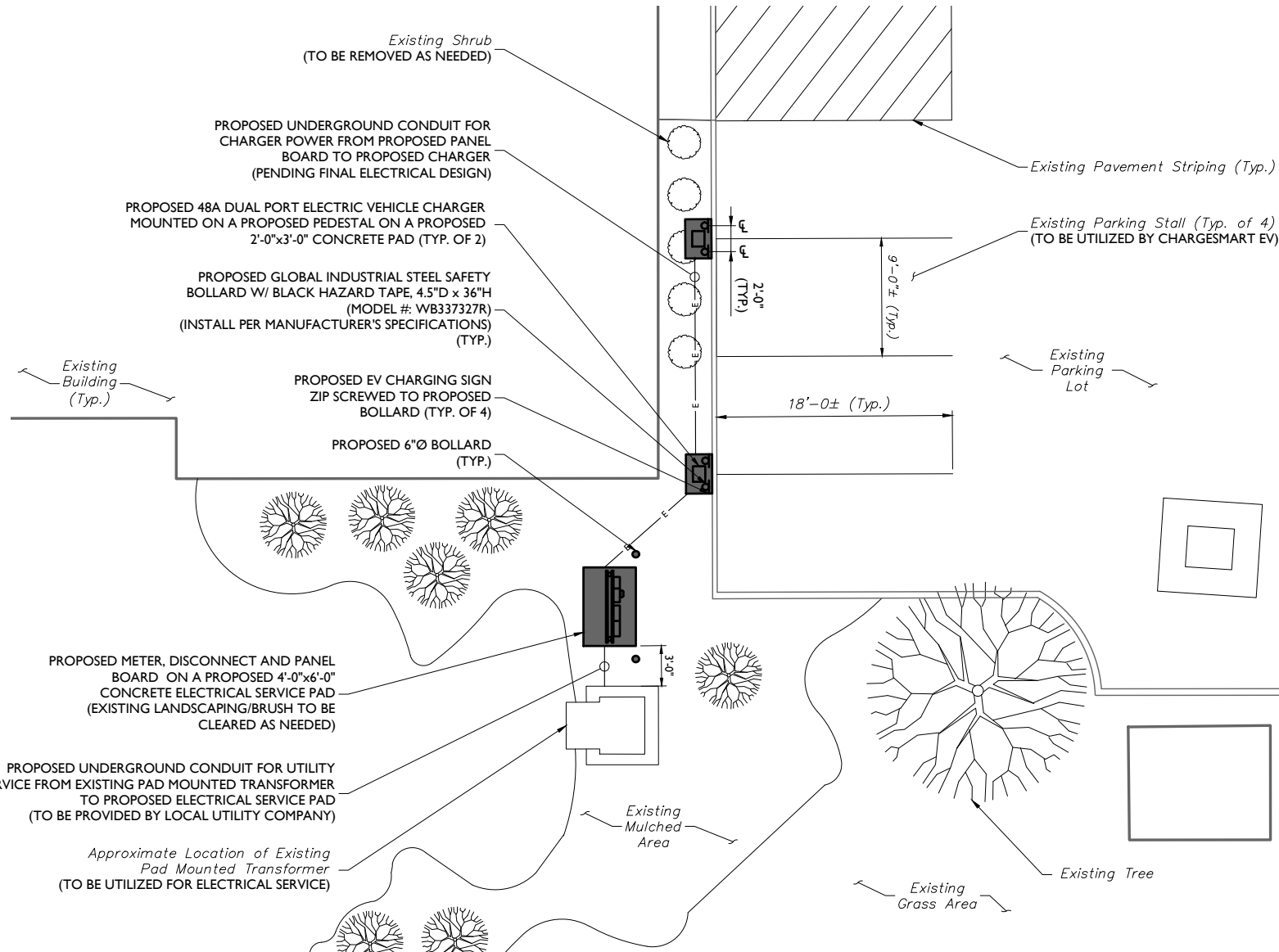

NOTE: DO NOT SCALE DRAWINGS FOR CONSTRUCTION

AcPublish_18768\Fairfield Inn and Suites Rochester East.CD_Rev A.dwg\A-1 By: RYAN.DEVANY

CHARGESMART 19.2kW EV CHARGER (LEVEL 2)
NOT TO SCALE



Colliers Engineering
& Design

www.colliersengineering.com

Copyright © 2025, Colliers Engineering & Design All Rights Reserved. This drawing and all the information contained herein is authorized for use only by the party for whom the services were contracted or to whom it is certified. This drawing may not be copied, reused, disclosed, distributed or relied upon for any other purpose without the express written consent of Colliers Engineering & Design.



ChargeSmart EV



PROTECT YOURSELF

ALL STATES REQUIRE NOTIFICATION OF EXCAVATORS, DESIGNERS, OR ANY PERSONS PREPARING TO DISTURB THE EARTH'S SURFACE ANYWHERE IN ANY STATE

FOR STATE SPECIFIC DIRECT PHONE NUMBERS VISIT
WWW.CALL811.COM

SCALE: AS SHOWN

JOB NUMBER : 25902012

1	+	+	1	+	+
2	+	+	2	+	+
3	+	+	3	+	+
4	+	+	4	+	+
5	+	+	5	+	+
6	+	+	6	+	+
7	+	+	7	+	+
8	+	+	8	+	+
9	+	+	9	+	+
10	+	+	10	+	+

A	04/21/25	ISSUED FOR REVIEW	JJK	SLM
REV	DATE	DESCRIPTION	DRAWN BY	CHECKED BY

Stephanie Mulhern

NEW YORK LICENSED PROFESSIONAL ENGINEER
 LICENSE NUMBER: 110126
 COLLIERS ENGINEERING & DESIGN CT, P.C.
 N.Y. C.O.A #: 0017609

IT IS A VIOLATION OF LAW FOR ANY PERSON,
UNLESS THEY ARE ACTING UNDER THE DIRECTION
OF THE RESPONSIBLE LICENSED PROFESSIONAL
ENGINEER, TO ALTER THIS DOCUMENT.

SITE NAME:

FAIRFIELD INN AND SUITES

915 HARD ROAD
WEBSTER, NY 14580
MONROE COUNTY



Engineering
& Design

MT. LAUREL
2000 Midlantic Drive,
Suite 100
Mt. Laurel, NJ 08054
Phone: 856.797.0412
COLLIERS ENGINEERING & DESIGN,
ARCHITECTURE, LANDSCAPE ARCHITECTURE
SURVEYING CT, P.C.

SHEET TITLE

PROJECT DETAILS

SHEET NUMBER

A-1

NOTE: DO NOT SCALE DRAWINGS FOR CONSTRUCTION

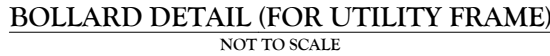



- 2.c.8. TOTAL DELIVERY TIME SHALL BE LESS THAN 75 MINUTES.